

SHILOH COMMERCE CENTER

2700 N Shiloh Road - Building A
Richardson, TX 75082

FOR SALE

33,490 SF - New Construction
Freestanding Industrial Building



Delivery Q2 2020!

BUILDING FEATURES

- Building Size: 33,490 SF
- Lot Size: 88,118 SF
- Office: Up to 4,000 SF
- Loading: 4 Dock-High
1 Ground Level
1 Ramped
- Clear Height: 24' minimum
- Zoning: Industrial - PD
- Sprinklers: ESFR
- Power: 400 amps, 3-phase
- Parking: 48 spaces
- Location: Visibility from
George Bush Tollway

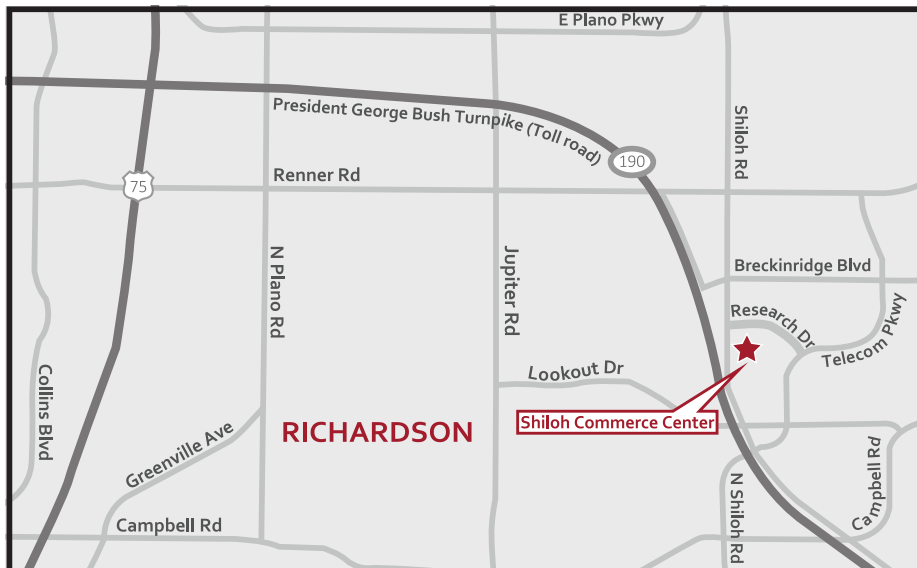

For more Information, please contact:



GILLETT COMMERCIAL
Real Estate Brokerage & Development

(469) 425-4182

SHILOH COMMERCE CENTER

2700 N Shiloh Road - Building A
Richardson, Texas 75082

FOR SALE

33,490 SF - New Construction

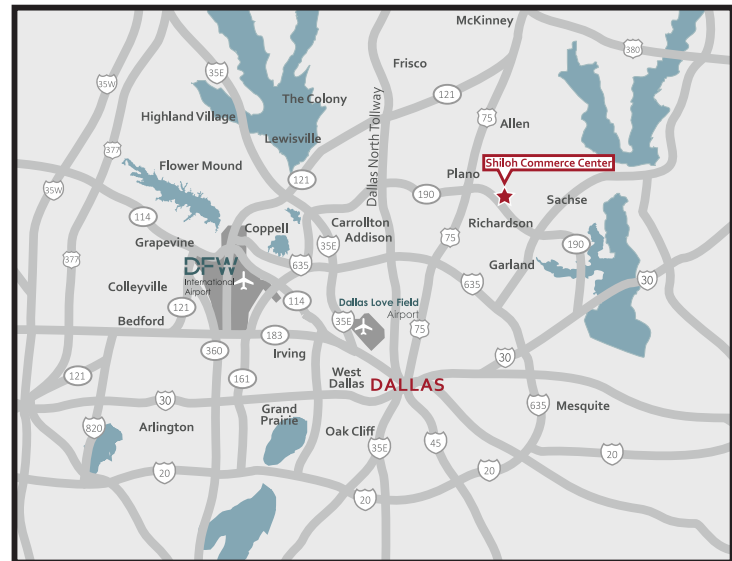
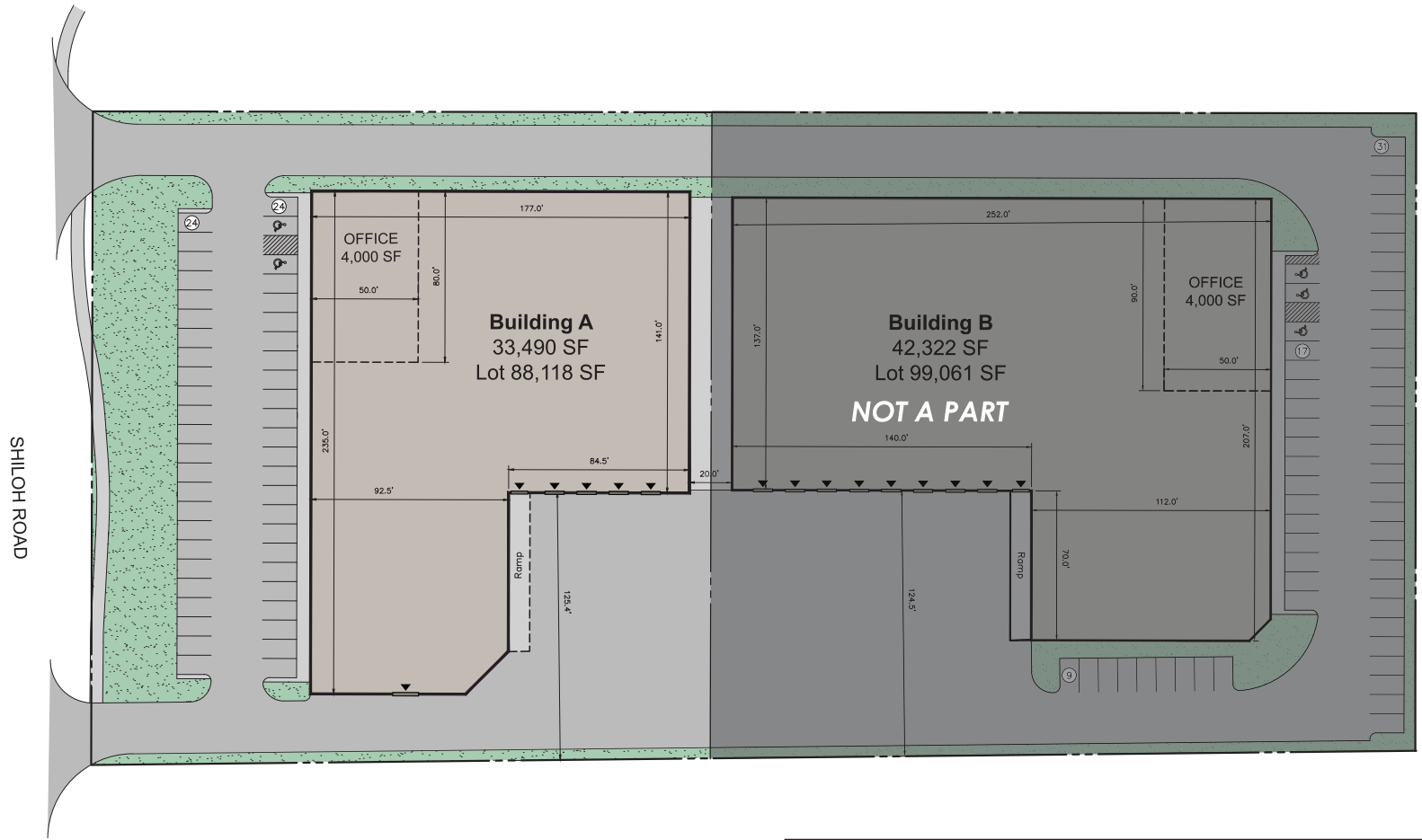

GILLETT COMMERCIAL

Real Estate Brokerage & Development

Bucky Gillett

(949) 422-7227 cell

bucky@gillettcommercial.com

For more Information, please contact:

(469) 425-4182

Kirstin Emershaw

(949) 274-2015 cell

kirstin@gillettcommercial.com